



SmartVU Home Wireless Smart Plug

Quick Start Guide



www.smartvuhome.co.nz

Please read this Quick Start Guide carefully before using,
and keep it for future reference.

1. Download the SmartVU Home App

If you haven't already, download and register an account on the free SmartVU Home app.



It is available on both iOS and Android.

Simply search "SmartVU Home" or you can scan the QR Code below.



Launch the SmartVU Home app from your phone or tablet and select the Register button.

Follow the on-screen instructions.

2. Connection Preparation

Insert your SmartVU Home Wireless Plug into a suitable power source and switch ON.

The SmartVU Home app supports TWO pairing modes: Smart Mode and AP Mode.

Smart Mode:

Once the SmartVU Home Wireless Plug is switched ON, to enter pairing mode, press and hold the RESET button for 5 seconds.

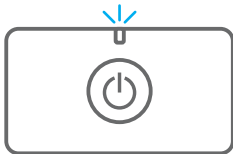

The indicator on the Wireless Plug will start blinking rapidly, twice per second.

AP Mode:

Once the indicator on the Wireless Plug is blinking rapidly, press and hold the RESET button for another 5 seconds.

The indicator on the Wireless Plug will start blinking slowly, once every three seconds.

3. Add Device

Once the SmartVU Home Wireless Plug is in pairing mode, select **Add Device** or  in the SmartVU Home app.

Select **Electrical**, then **Socket (Wi-Fi)**.

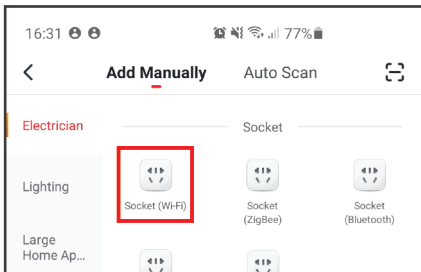

Follow the app's on-screen instructions.

By default the SmartVU Home app will attempt pairing in Smart Mode.

Confirm the Wireless Plug's indicator is blinking rapidly, and select **Confirm Indicator's rapidly blinking** to proceed.

Otherwise, if the Wireless Plug's indicator is blinking slowly, select **Other Mode** in the top-right, then **AP Mode**.

3. Add Device

Once you've confirmed the Wireless Plug is blinking rapidly, you'll be prompted to enter the Wi-Fi Password.

NOTE: Make sure your phone or tablet is connected with your Wireless Router. Please note the Wireless Plug will only connect to 2.4GHz Wi-Fi, not 5GHz Wi-Fi.

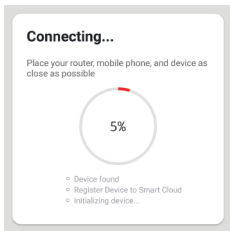
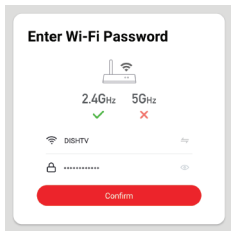

The SmartVU Home app will scan and connect to the Wireless Plug, showing **Device Added Successfully**.

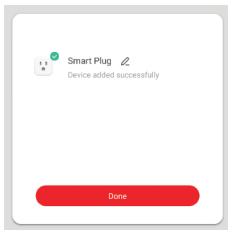

4. Control Device

Once the Wireless Plug has been added successfully, you can open the control options.

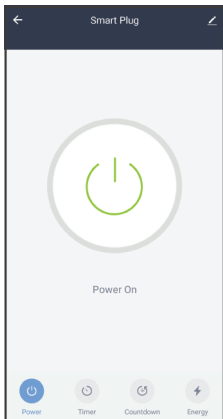

Fig-1

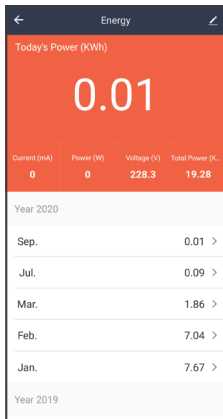

Fig-2

For example, Fig-1 shows the Wireless Plug is ON, with options like Energy, Countdown, and Timer available to be configured. Fig-2 shows the Energy option, view and check the connected appliance's real-time and historical power consumption.

NOTE: Select **Edit**  to rename the Wireless Plug.

5. Troubleshooting

For more information, visit www.smartvuhome.co.nz

Unable to pair the Wireless Plug with the App.

Option 1: Ensure your phone or tablet is connected to a 2.4GHz Wi-Fi Network.

Option 2: Check that the Wireless Plug is in the correct pairing mode. Eg. If the Wireless Plug is blinking slowly, the Smart Mode pairing option won't connect.

Option 3: Check the Internet connection on your Wi-Fi Network.

Option 4: If pairing via Smart Mode, ensure the Wi-Fi Password entered is correct, and you're connecting to the same Wi-Fi Network as your phone or tablet.

Option 5: Try set up the Wireless Plug closer to your Router.

6. Specification

- Model Number: SHWSP1
- Input: 240V A.C. 50Hz
- Max Total Load: 10A 2400W
- Wireless: 2.4GHz only

FOR INDOOR USE ONLY

smartvuhome

SmartVU Home Wireless Plug

Connect & Control. Anytime. Anywhere.

© 2020 Dish TV Technologies Ltd. SmartVU Home is a trademark of
Dish TV Technologies Ltd.

Google and Google Play are trademarks of Google LLC.
Apple® and the App Store® are trademarks of Apple Inc.